

ALLDAY  
& MILLER



Swallow Street, Iver, SL0 0ET  
£2,500

4 2 1 D



Swallow Street, Iver, SL0 0ET

**£2,500**

- Four Bedrooms
- Large Private Garden
- 2 Shower Rooms
- Ideal Family Home
- Unfurnished
- Off Street Parking for 4 cars
- Large Through Lounge
- Close To Local Amenities
- 1239 Sq Ft
- Available From 7th September

## Description

This well presented property comprises of living/dining room, shower room, fitted kitchen with an island overlooking the rear garden. The first floor features three bedrooms and a family bathroom. To the second floor enjoys a double bedroom and en suite.

Other benefits include a driveway creating space for off street parking and a private rear garden ideal for outside dining.

## Situation

Swallow Street is set in a semi-rural village, local to the High Street, with shops and amenities. Uxbridge town centre is easily accessible, with a wide range of shopping and dining facilities; as well as the underground station servicing the Metropolitan and Piccadilly lines. Iver and Langley overground stations are nearby, with swift and direct access to Paddington, Liverpool Street and Canary Wharf via the Elizabeth Line. Central London is also easily accessible by road via the M40 (J1A), M25 (J16) and M4 (J5). In addition, Heathrow Airport is also a short drive away.



## Floor Plans

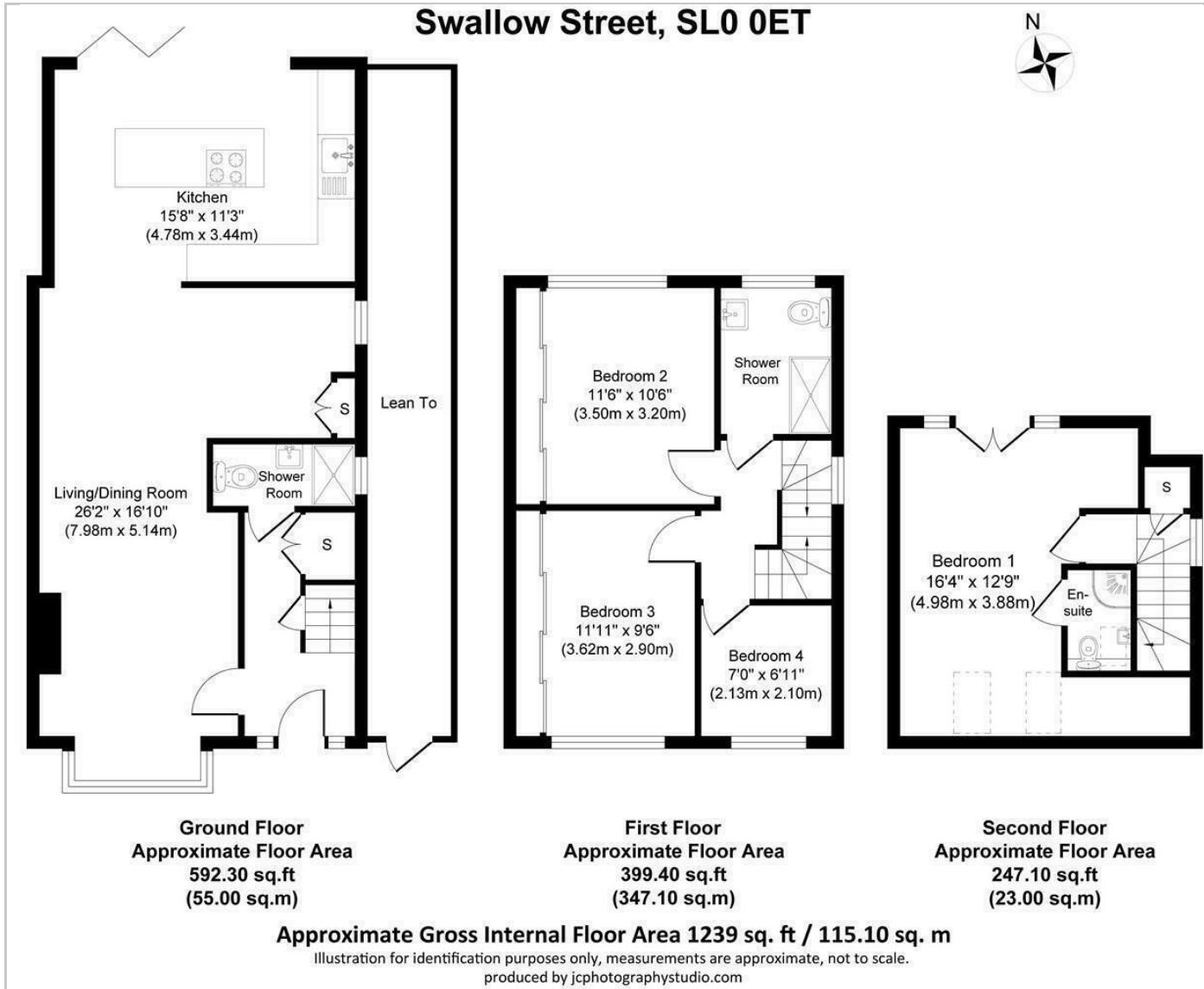

## Area Map

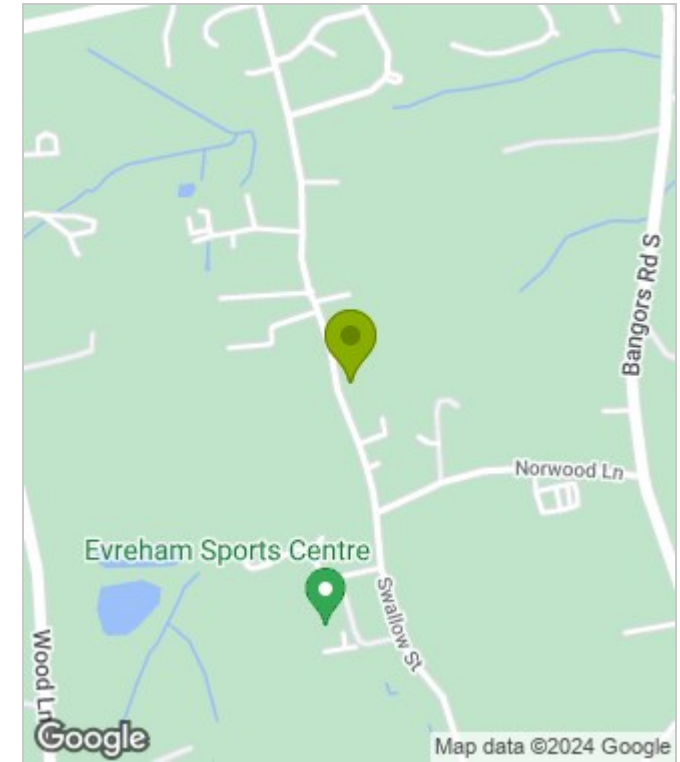

## Energy Performance Graph

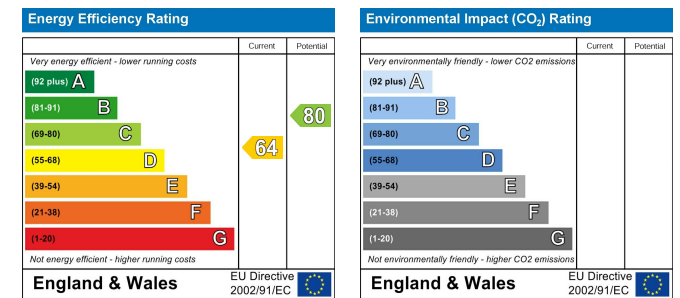

These particulars, whilst believed to be accurate are set out as a general outline only for guidance and do not constitute any part of an offer or contract. Intending purchasers should not rely on them as statements of representation of fact, but must satisfy themselves by inspection or otherwise as to their accuracy. No person in this firm's employment has the authority to make or give any representation or warranty in respect of the property.

[www.alldayandmiller.co.uk](http://www.alldayandmiller.co.uk)

192 High Street, Uxbridge, Middlesex, UB8 1LB

T: 01895 641 000 | E: [sales@alldayandmiller.co.uk](mailto:sales@alldayandmiller.co.uk)  
T: 01895 379 549 | E: [lettings@alldayandmiller.co.uk](mailto:lettings@alldayandmiller.co.uk)